

GEORGE T. DUNHAM
SURVEYING & SUBDIVIDING
DELAVER, WISCONSIN

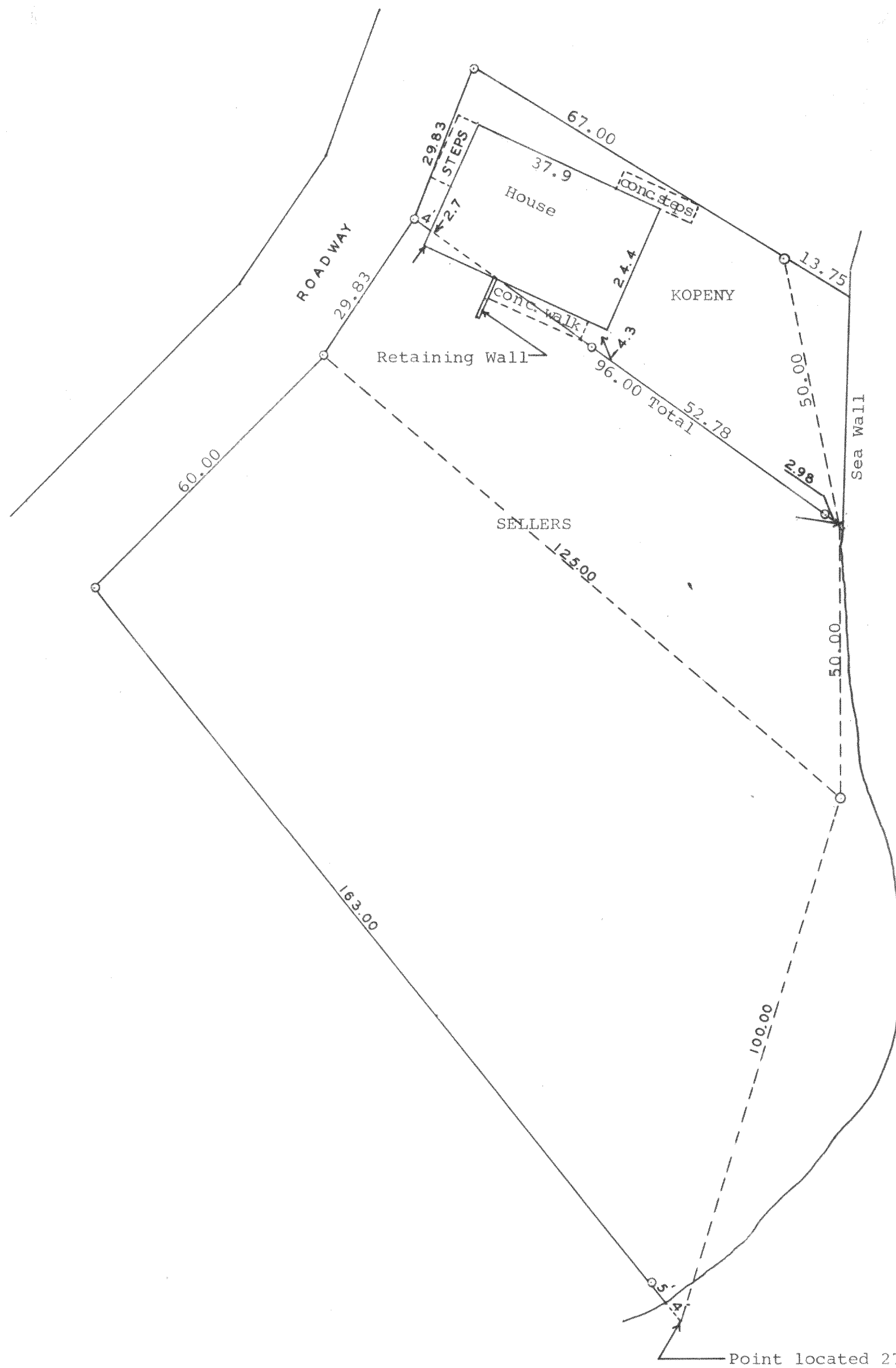

Scale - 1" = 20'
O = Iron Pipe
x = Cross in Concrete

Plat of survey of parcels of land located in Block 1
of Carswells Park in Sections 35 and 36, T 4 N, R 16 E,
Walworth County, Wisconsin.
October 2, 1970

George T. Dunham
George T. Dunham, Surveyor

HCA-6
part of
11.8

416-90